



Contemporary Style with a Touch of Class

4 3 2

Nestled quietly at the head of a leafy court, this stunning family residence showcases an abundance of natural light, superb living spaces and all the conveniences needed for a modern family lifestyle.

Step into a relaxing open plan living/dining area with warm wooden floors, high ceilings and sliding doors to a covered north-facing terrace. Prepare meals in the entertainer's kitchen, brilliantly lit with skylights and equipped with Caesar stone benchtops, double sink, walk in pantry and stainless steel Smeg appliances. There is a spacious guest bedroom downstairs with lush carpet and an adjacent powder room with shower. The deluxe master bedroom upstairs has views across the city, walk in robe, lavish ensuite and is complemented by two further bedrooms and an upstairs living area, providing plenty of room for a growing family.



> Paul Richards

Phone :0398152999

Mobile :0414503324

Email :paul@bekdonrichards.com.au



> May Zhu

Phone :0398152999

Mobile :0434441331

Email :may@bekdonrichards.com.au

18 Heather Court, HAWTHORN EAST



GROUND FLOOR



FIRST FLOOR

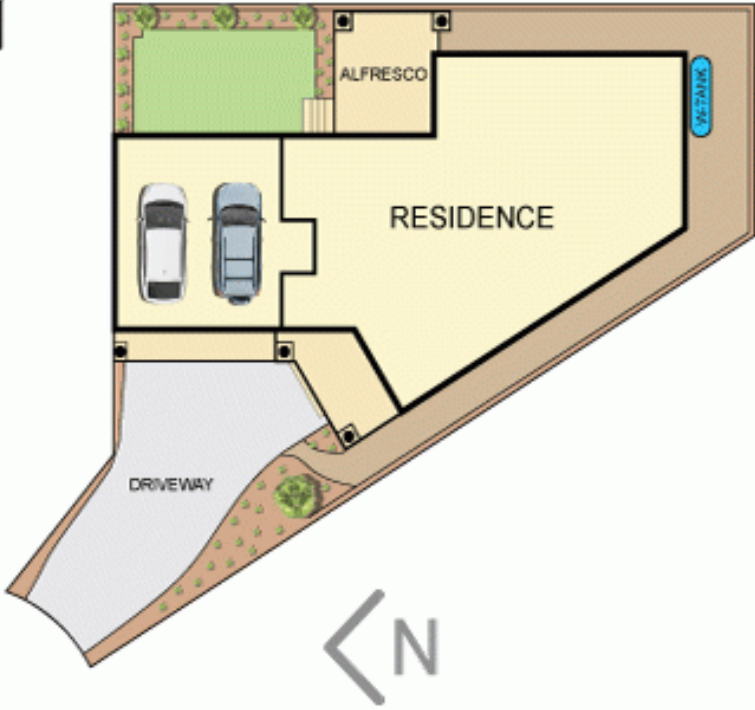

Disclaimer: The artist impressions and floorplans are indicative only, are not to scale and do not form part of any Contract of Sale. Any dimensions, finishes or specifications depicted are subject to change without notice. Consultants and agents do not warrant the accuracy of any information provided and do not accept any liability for negligence, any error, misrepresentation, discrepancy in the information or reliance thereon.