



## Quality Family Home in Exceptional Family Location

4 3 3

Boasting immense street presence and set within a charming tree-lined family neighbourhood, this brand new elevated contemporary home is set behind established low maintenance landscaped gardens, located within easy walking distance of Wattle Park, quality local and independent schools, and Wattle Park village shopping and cafes.

An inviting wide entry hallway leads visitors to an open plan living and dining space with wall mounted gas fireplace, flowing directly out to a spacious skylit north facing alfresco entertaining area adjacent to a lawn bordered by manicured garden beds. A showpiece entertainers' kitchen is awash with natural light, featuring an oversized waterfall island bench, marble effect stone benchtops and splashback, Miele appliances, gas cooktop, semi-integrated dishwasher, 39 Boisdale Street



> Evan Lykourinos

Phone :0398152999

Mobile :0414555455

Email :enquiries@bekdonrichards.com.au



> Mark Kainey

Phone :0398152999

Mobile :0414555455

Email :mark@bekdonrichards.com.au



**GROUND FLOOR**

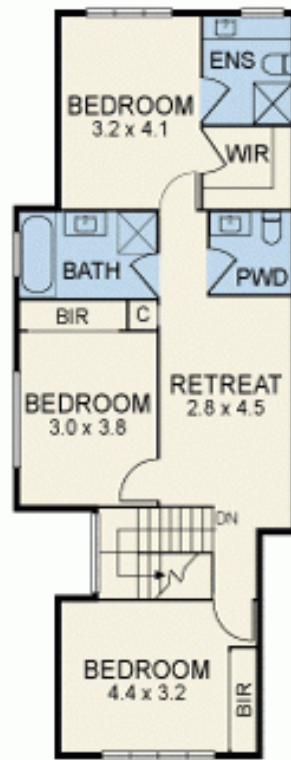
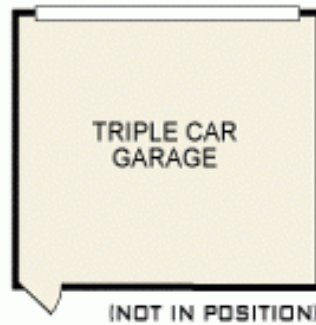

**FIRST FLOOR**

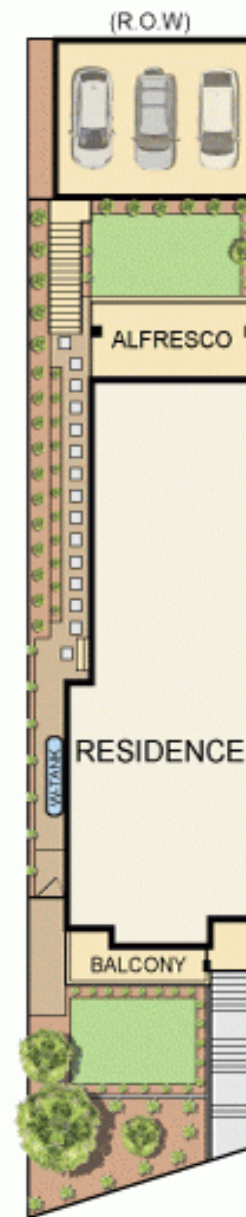

Disclaimer: The artist impressions and floorplans are indicative only, are not to scale and do not form part of any Contract of Sale. Any dimensions, finishes or specifications depicted are subject to change without notice. Consultants and agents do not warrant the accuracy of any information provided and do not accept any liability for negligence, any error, misrepresentation, discrepancy in the information or reliance thereon.