



Elegant lifestyle in leafy Kew

3 2 2

Positioned within an elegant garden enclave of prestigious town residences, this impeccably presented home showcases gleaming parquetry flooring, lofty ceilings and a low maintenance private courtyard. Offering an exceptional opportunity for a secure lifestyle in a sought-after location, the home is within easy walking distance of local Willsmere Village shopping and cafes, leafy Anniversary Trail, offering effortless city access via the nearby Eastern Freeway.

On the main floor, a formal living room leads through to an open plan living and dining area, which flows seamlessly out via a full wall of bifold glass doors to a sun drenched alfresco patio. Adjacent, a leafy courtyard garden is ideally positioned for effortless outdoor dining and entertaining. With an oversized granite island bench and breakfast bar, the kitchen also comprises a gas cooktop, semi-integrated dishwasher, and ample



> Paul Richards

Phone :0398152999

Mobile :0414503324

Email :paul@bekdonrichards.com.au



> May Zhu

Phone :0398152999

Mobile :0434441331

Email :may@bekdonrichards.com.au

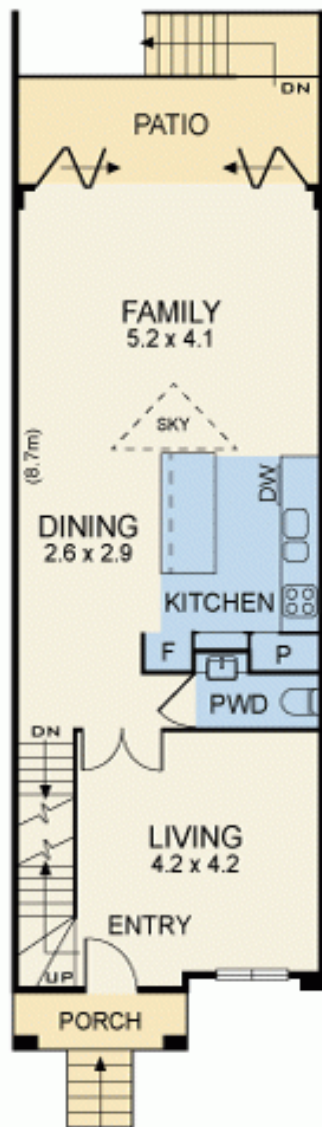

GROUND FLOOR

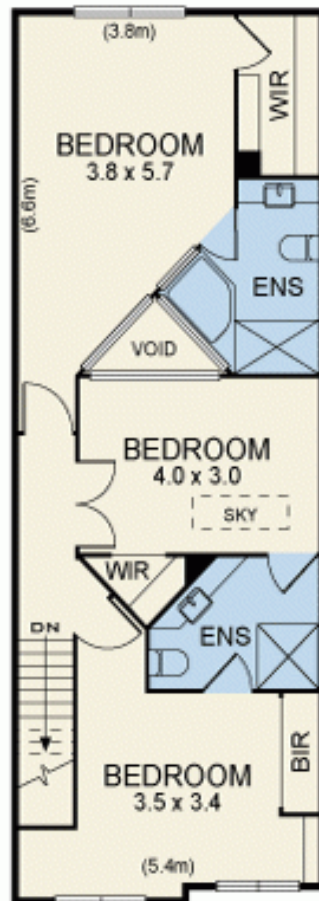

FIRST FLOOR

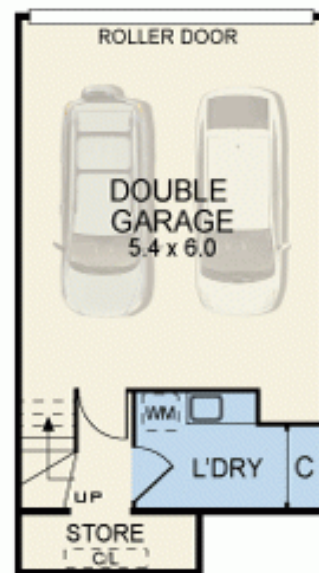

**LOWER
GROUND FLOOR**



Disclaimer: The artist impressions and floorplans are indicative only, are not to scale and do not form part of any Contract of Sale. Any dimensions, finishes or specifications depicted are subject to change without notice. Consultants and agents do not warrant the accuracy of any information provided and do not accept any liability for negligence, any error, misrepresentation, discrepancy in the information or reliance thereon.