



## Period grace with contemporary space

5 2 2

Harmoniously integrating an impressive contemporary extension with graceful Victorian character, this generous five bedroom residence presents an impeccable period façade with abundant space for relaxed family living and entertaining. Nestled within a highly sought-after and friendly local neighbourhood, the home is positioned just a short stroll to Auburn South Primary School, trams, local village cafes, McCoppins Grocer, and the vibrant Camberwell Junction shopping and restaurant precinct.

Showcasing soaring high ceilings with ornamental mouldings and an open fireplace, a formal living room is set at the entry, while the quality rear extension features an expansive open plan living and dining area, awash with abundant natural light and offering a wall mounted gas log fireplace and inbuilt cabinetry. A second casual living area / bedroom / large home office with open fireplace provides



> Paul Richards

Phone :0398152999

Mobile :0414503324

Email :paul@bekdonrichards.com.au



> May Zhu

Phone :0398152999

Mobile :0434441331

Email :may@bekdonrichards.com.au

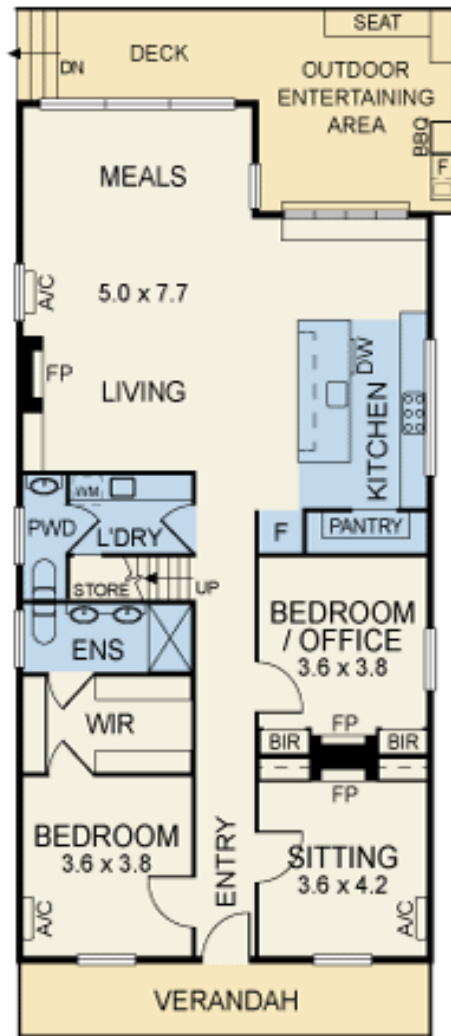

GROUND FLOOR



(NOT IN POSITION)

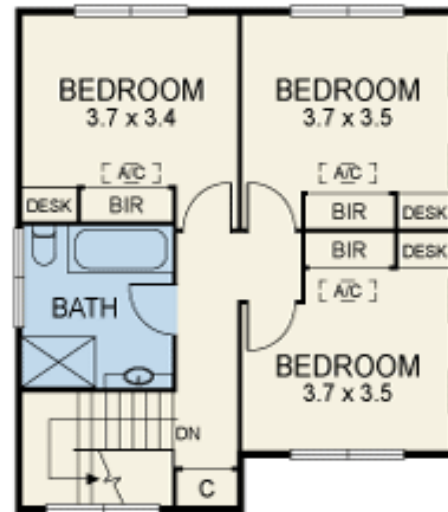

FIRST FLOOR

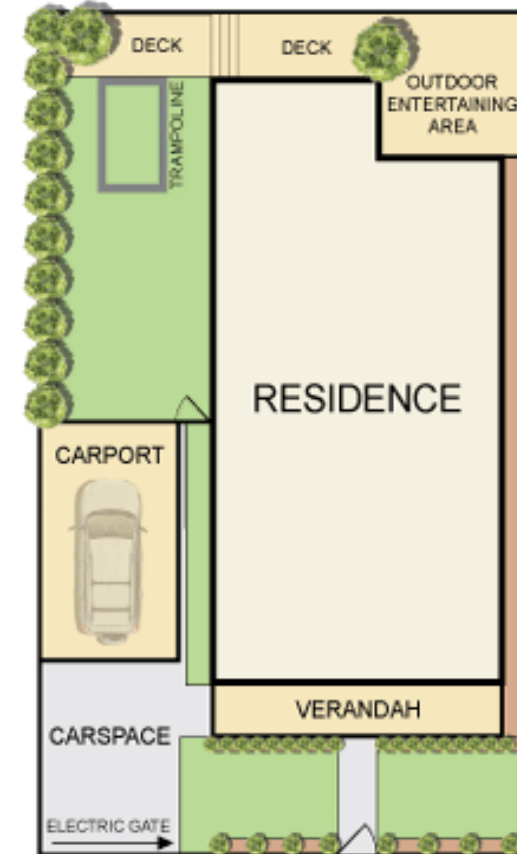

Disclaimer: The artist impressions and floorplans are indicative only, are not to scale and do not form part of any Contract of Sale. Any dimensions, finishes or specifications depicted are subject to change without notice. Consultants and agents do not warrant the accuracy of any information provided and do not accept any liability for negligence, any error, misrepresentation, discrepancy in the information or reliance thereon.