



North facing renovated home in idyllic leafy location

2 1 1

Boasting an enviable leafy location just metres from trams, Mason Street Playground and Smart Street Reserve, this charismatic character residence has been tastefully renovated to showcase light-filled contemporary interiors, with a sun-drenched north facing courtyard garden ideal for relaxed outdoor entertaining. Set within easy walking distance of local cafes, St James Park, Yarra River parklands and Hawthorn Station, the home is also just a moment from the vibrant shopping and restaurant precincts of both Richmond and Hawthorn, with Victoria Gardens and Swinburne University also within close reach.

18 Simpson Place



> Paul Richards

Phone :0398152999

Mobile :0414503324

Email :paul@bekdonrichards.com.au



> May Zhu

Phone :0398152999

Mobile :0434441331

Email :may@bekdonrichards.com.au

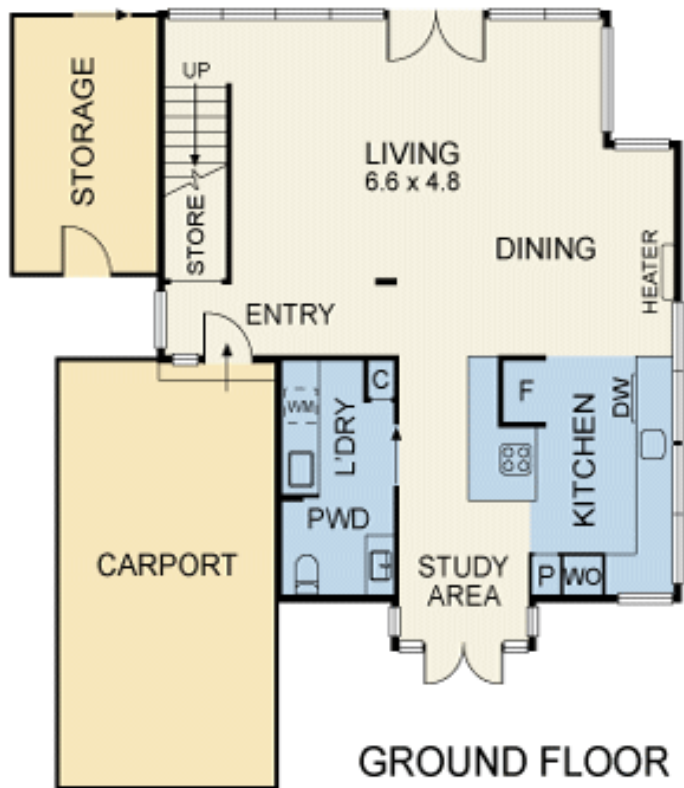

Disclaimer: The artist impressions and floorplans are indicative only, are not to scale and do not form part of any Contract of Sale. Any dimensions, finishes or specifications depicted are subject to change without notice. Consultants and agents do not warrant the accuracy of any information provided and do not accept any liability for negligence, any error, misrepresentation, discrepancy in the information or reliance thereon.