



## The best in family living in a cherished Templestowe Lower pocket

5 3 2

Offering elevated brilliance with a design that favours families, exceptional views from a number of wonderful balcony areas, and a peaceful Templestowe Lower location close to schools and Ruffey Lake Park, this unforgettable 4 bedroom + study, 3 bathroom residence is your ticket to family greatness!

Sitting on a raised 786 sqm (approx.) block and with a quality construction which includes double brick throughout so much of the home, this owner-built abode is first time offered in 32 years. While perfect to live in as is, this dwelling is also open to some modern updates if you wanted a fresh start!

19 Romilly Avenue



> Paul Richards

Phone :0398152999

Mobile :0414503324

Email :paul@bekdonrichards.com.au



> May Zhu

Phone :0398152999

Mobile :0434441331

Email :may@bekdonrichards.com.au

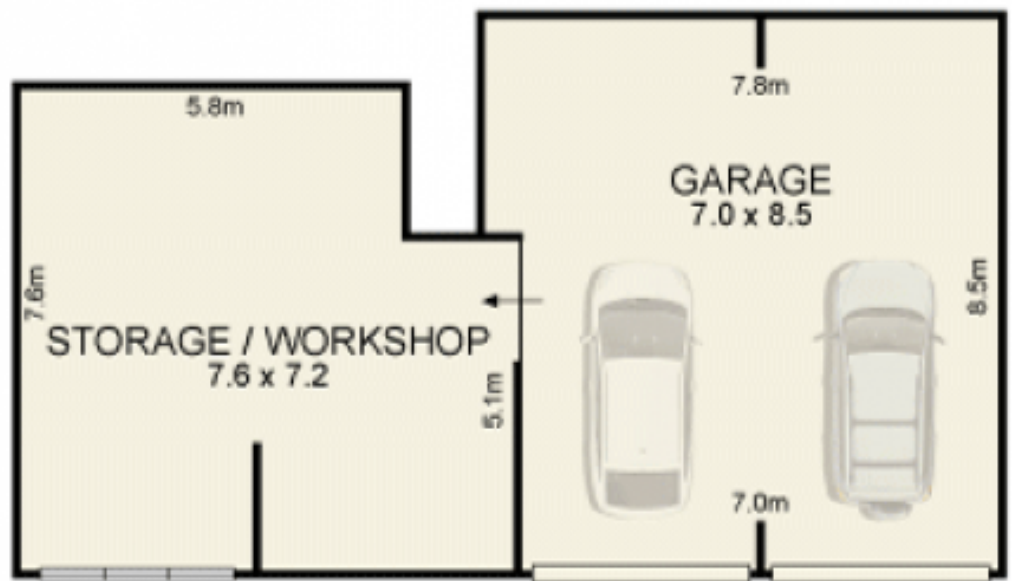

**LOWER GROUND FLOOR**

