



Classic Home with Impressive Dimensions within Box Hill High zone

3 2 2

Do not be influenced by the address of this property, for this is no ordinary unit! Stretching wide at the front of its complex, this surprisingly spacious period residence delivers generous proportions, immediate comfort and plenty of future potential.

Accessed via the service lane and set behind a generous leafy front garden, the accommodation features lofty ceilings and original hardwood floors through the social areas of the layout which comprise a huge lounge and elegant separate dining zone.

7/1093 Whitehorse Road



> Paul Richards

Phone :03 9815 2999

Mobile :0414 503 324

Email :paul@bekdonrichards.com.au



> John Ke

Mobile :0410 888 737

Email :john@bekdonrichards.com.au

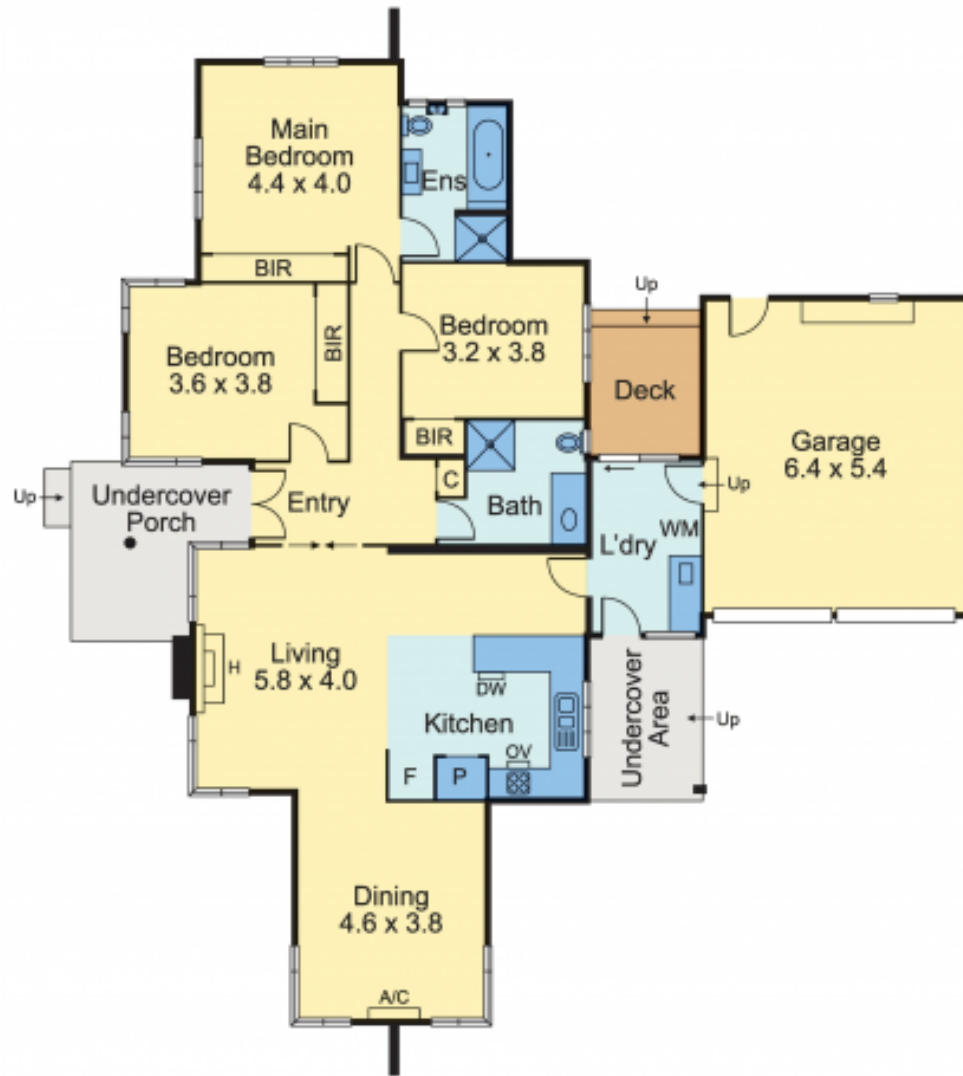

7/1093 Whitehorse Road, Box Hill